



## Prestige® Touch Screen Thermostat

### User Guide



## Welcome

Congratulations on your purchase of a touch screen programmable thermostat. When used with the optional RedLINK Internet Gateway, you can remotely monitor and control the heating and cooling system in your home or business—you can stay connected to your comfort system wherever you go.

Total Connect Comfort is the perfect solution if you travel frequently, own a vacation home, a business or manage an investment property or if you are simply looking for peace of mind.

# Features of your Prestige thermostat

With your new thermostat, you can:

- **Connect to the internet to monitor and control your heating/cooling system and receive alerts by email (requires optional RedLINK Internet Gateway)**
- **View outdoor temperature and humidity (requires optional Wireless Outdoor Sensor)**
- **Control humidification, dehumidification or ventilation**

Your new thermostat also provides:

- **Adaptive Intelligent Recovery—over time, the Prestige thermostat “learns” how long it takes your system to reach the temperature you want. It turns on the heating or cooling system earlier to make sure you’re comfortable at the time you expect.**
- **Dealer information on the screen—making it easy for you to contact your dealer for service.**
- **Vacation and holiday scheduling—allowing you to program a setback temperature to save energy while you are away.**
- **Keypad lockout to prevent unauthorized changes.**
- **Equipment status—provides on/off status of all equipment controlled by the thermostat.**
- **Preferences—allowing you to customize the thermostat to your desired settings.**

## Table of contents

### Programming and Operation

Quick reference.....	3
Setting the time/date.....	4
Setting the fan.....	4
Setting system mode.....	5
Preset energy-saving schedules.....	5
Adjusting program schedules.....	6
Schedule overrides.....	7

### Menu Options

Viewing equipment status.....	8
Setting vacation, holiday, and events.....	8
Setting holiday/event schedules: commercial use.....	9
Setting humidification and dehumidification.....	12

Setting ventilation.....	14
Setting preferences.....	14
Cleaning the thermostat screen.....	15
Security settings.....	15
Viewing dealer information.....	16
Advanced features.....	16

### Appendices

Installer options.....	17
Replacing batteries.....	17
Temperature and humidity display.....	18
Optional accessories.....	19
Troubleshooting.....	20
Regulatory information.....	21

## Quick reference: residential use



The diagram shows a residential thermostat interface with the following elements:

- HOME:** Touch to display Home screen.
- FAN:** Select fan mode.
- SYSTEM:** Select system mode (Heat/Cool).
- MENU:** Touch to display options. Start here to set a program schedule.
- Current schedule:** Touch an arrow to change temperature setting and select a Temporary or Permanent Hold.
- Indoor conditions:** Shows indoor temperature and humidity.
- Current date and time:** Shows current date and time.
- Current status:** Shows system mode (heat/cool), outdoor temperature and humidity (with optional outdoor sensor).

The interface displays: HOME, FAN, SYSTEM, MENU, Fri, Jun 14, 2013 6:30 pm, INDOOR 72°, OUTDOOR 80°/ 55% Humidity, 45% Humidity, SET TO 72°, STATUS cool mode, following schedule, and an OVERRIDE button.

## Quick reference: light commercial use

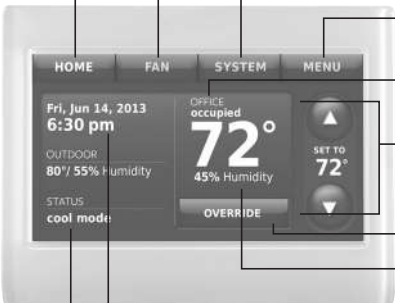

The diagram shows a light commercial thermostat interface with the following elements:

- HOME:** Touch to display Home screen.
- FAN:** Select fan mode.
- SYSTEM:** Select system mode (Heat/Cool).
- MENU:** Touch to display options. Start here to set a program schedule.
- Thermostat location:** Quickly identify which thermostat is in control of a specific area.
- Current schedule:** Touch an arrow to change temperature setting and set a temporary hold.
- Override:** Touch to temporarily override the program schedule.
- Indoor conditions:** Shows indoor temperature and humidity.
- Current date and time:** Shows current date and time.
- Current status:** Shows system mode (heat/cool), outdoor temperature and humidity (with optional outdoor sensor).
- USB port:** Use USB device to load holiday schedules and custom events.

The interface displays: HOME, FAN, SYSTEM, MENU, Fri, Jun 14, 2013 6:30 pm, OFFICE occupied, INDOOR 72°, OUTDOOR 80°/ 55% Humidity, 45% Humidity, SET TO 72°, STATUS cool mode, and an OVERRIDE button.

# Setting the time/date

- 1 Touch the current time. The screen displays **Set Time/Set Date**.
- 2 Touch **Set Time** or **Set Date**.
- 3 Touch ▲ or ▼ until the proper time/date is displayed.
- 4 Touch **Done** to save or **Cancel** to ignore changes.

 **NOTE:** The thermostat will automatically switch to and from Daylight Saving Time.

 **NOTE:** When used with the RedLINK Gateway, time/date is updated via the Internet. For some software versions of Prestige, installation without Gateway does not allow you to adjust time for 72 hours unless you remove the coin cell battery for a minute and then re-insert it.



# Setting the fan

- 1 Touch **FAN** to display fan settings.
- 2 Touch **On**, **Automatic**, **Circulate**, or **Follow Schedule**.
- 3 Touch **Done** to save and exit.

**On:** Fan is always on.

**Automatic:** Fan runs only when the heating or cooling system is on.

**Circulate:** Fan runs randomly about 35% of the time (residential use only).

**Follow Schedule:** Fan controlled by program (see pages 5–7).

 **NOTE:** In commercial use, touch Auto or On to temporarily override the programmed fan schedule.



# Setting system mode

1 Touch **SYSTEM** to display system settings.

2 Touch desired option:

**Heat:** Thermostat controls only the heating system.

**Cool:** Thermostat controls only the cooling system.

**Off:** Heating/cooling systems are off.

**Automatic:** Thermostat selects heating or cooling as needed depending on the indoor temperature.

**Emergency Heat (heat pumps with aux. heat):** Controls auxiliary/ emergency heat. Compressor is locked out.

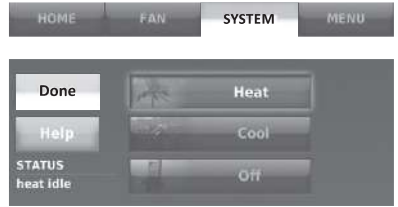

3 Touch **Done** to save and exit.



**NOTE:** The **Automatic** and **Emergency Heat** system settings may not appear, depending on how your thermostat was installed.

# Preset energy-saving schedules

This thermostat uses default Energy Saver settings that can reduce your heating/cooling expenses. To customize settings, see next page.

Residential Use	Period	Start time	Heat (Mon-Fri)	Cool (Mon-Fri)	Heat (Sat-Sun)	Cool (Sat-Sun)
	<b>Wake</b>	6:00 am	70°	78°	70°	78°
<b>Leave</b>	8:00 am	62°	85°	62°	85°	
<b>Return</b>	6:00 pm	70°	78°	70°	78°	
<b>Sleep</b>	10:00 pm	62°	82°	62°	82°	

Commercial Use	Period	Start time	Heat	Cool	Fan
	<b>Occupied 1</b>	8:00 am	70°	75°	On
<b>Unoccupied 1</b>	10:00 pm	55°	85°	Auto	
<b>Occupied 2*</b>	12:00 am	70°	75°	On	
<b>Unoccupied 2*</b>	12:00 am	55°	85°	Auto	

\* Period 2 is cancelled by default. If you activate it, the values shown above are default settings.

# Adjusting program schedules

- 1 Touch **MENU**.
- 2 Select **Create/Edit Schedule**.
  - Touch **Guide Me** to create a schedule by answering simple questions.
  - Touch **I'll do it myself** to manually create a program schedule.
  - Touch **View/Edit** to view the full schedule and make a quick adjustment.

 **NOTE:** To reduce costs, use the pre-set Energy Saver settings described on page 5.

- 3 Select the days to schedule, touch **Next**.
- 4 Touch **Wake** to set your Wake time for selected day(s).
- 5 Touch ▲ or ▼ to set Heat and Cool temperatures for the Wake period, then touch **Done**.
- 6 Touch other time periods (**Leave**, **Return**, **Sleep**) to set time and temperatures for each.
- 7 Touch **Done** to save and exit.

 **NOTE:** Touch **Delete Period** to eliminate any unwanted time period.

 **NOTE:** Touch **Fan Settings** to customize fan settings for any time period.

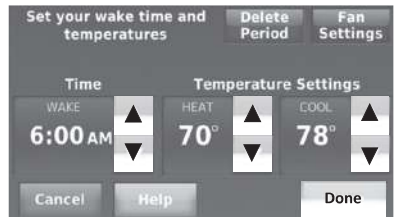
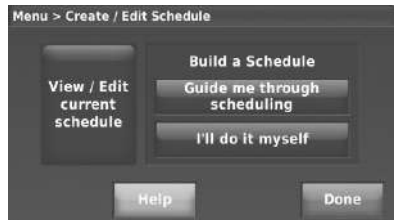
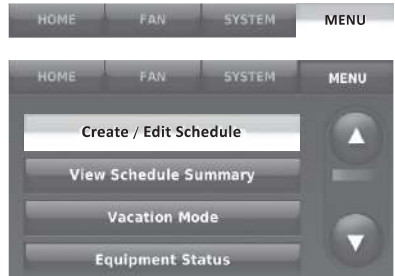

# Overriding schedules: residential use

- 1 Touch ▲ or ▼ to adjust the temperature (right side of screen) and the Hold Until time (left side). The schedule will resume when the Hold Until time expires.
- 2 Touch **Switch to Permanent Hold** to keep the same temperature until you change it or resume the program schedule.
- 3 Touch **Cancel Hold** at any time to resume the program schedule.



# Overriding schedules: commercial use

Touch ▲ or ▼ to adjust the temperature. It will be maintained until the hold time you set.

- To change the hold time, touch the Hold Until arrow buttons. This time can be adjusted up to the maximum time set by the installer.
- Touch **Override** to use a pre-set occupied temperature if a person uses the room during an unoccupied period. The new temperature will be maintained for 1 hour and can be adjusted up to the maximum time set by the installer.

The programmed schedule will resume when the override timer expires. Touch **Cancel Hold** at any time to resume the program schedule.



# Viewing equipment status

- 1 Touch **MENU**.
- 2 Select **Equipment Status**.
- 3 Touch ▲ or ▼ to view the status of all the equipment your thermostat is controlling. Depending on how your thermostat was installed, the Equipment Status screen can report data about the following systems:
  - Heating and cooling
  - Fan
  - Humidification
  - Dehumidification
  - Ventilation
  - Maintenance reminders
  - Thermostat information.



# Setting vacation hold: residential use

This feature helps you save energy while you are away, and restores comfortable settings just before you return home.

- 1 Touch **MENU**.
- 2 Select **Vacation Mode**.
- 3 Touch ▲ or ▼ to select the date you leave, then touch **Next** for further scheduling details, including times of day, temperature settings, return date, and return settings.
- 4 Review your selections on the last display, and touch **Done** to save your settings. Touch **Back**, then **Cancel** to ignore the changes.

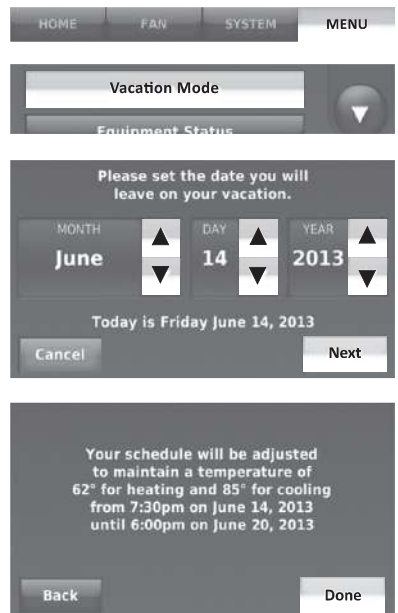

# Setting holiday/event schedules: commercial use

This feature helps you conserve energy when the workplace is unoccupied for special events and holidays.

- 1 Touch **MENU**.
- 2 Select **Holiday/Event Scheduler**.
- 3 Select the item you want to schedule.
  - Custom Events lets you set up other days for special schedules.
  - US and Canadian Holiday options let you select from a list of holidays commonly observed in each country.
- 4 Make selections as prompted on each screen. For more information, see next two pages.
- 5 Touch **Done** to save your settings.

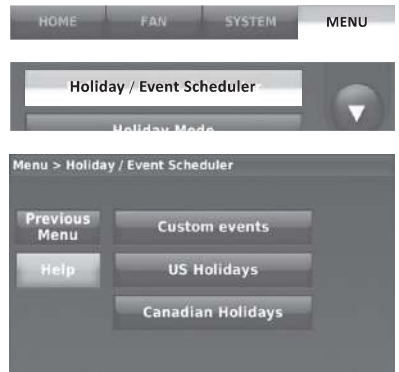

# Setting custom events: commercial use

This feature lets you customize temperature settings to be maintained during a specific event. You can set up an event for a specific date or day in a month. The thermostat resumes normal scheduling after the event.

- 1 Select **Custom events** from the Holiday/Event Scheduler menu.
- 2 Select **Create a new event**.
- 3 Select **Specific Date** or **Month/Weekday**.
  - For **Specific Date**, you are prompted to select the start date, settings, end date, and frequency for the event.
  - For **Month/Weekday**, you are prompted to select the month, day of the week, week of the month, settings, length of event, and frequency of the event.

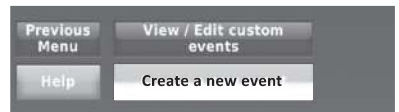

# Setting custom events: commercial use (continued)

- 4 Review the settings and touch **Done** to save them. Touch **Back**, then **Cancel** to ignore the changes.

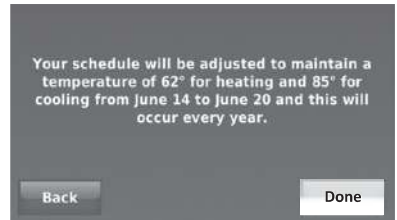

# Setting holiday schedule: commercial use

This feature lets you customize temperature settings to be maintained on specified national holidays. The thermostat resumes normal scheduling between selected holidays.

- 1 Select **US Holidays** or **Canadian Holidays** from the Holiday/Event Scheduler menu.
- 2 Select **Add/Edit Holidays**. A list of national holidays is displayed.
- 3 Touch the check box next to each holiday for which you want to maintain specific settings, (Touch ▲ or ▼ to scroll through the holiday list.) then touch **Next**.



Set the holiday schedule for Occupied or Unoccupied temperatures, depending whether the building will be in use.

- 4 Touch ▲ or ▼ to select the Heat and Cool temperatures.
- 5 Review the settings and touch **Done** to save them. Touch **Back**, then **Cancel** to ignore the changes.

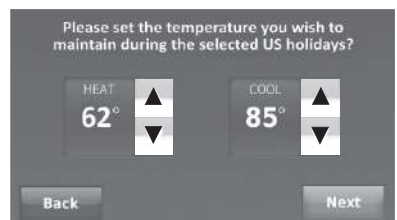
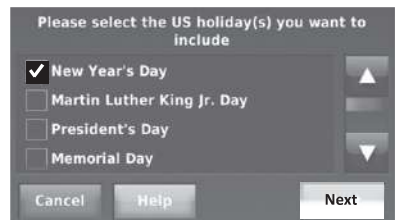

# Setting holiday override: commercial use

This feature lets you customize temperature settings to be maintained from now until a specified date. The thermostat resumes normal scheduling on the date you select.

- 1 Touch **MENU**.
- 2 Select **Holiday Mode** to display temperatures while you are away on holiday.
- 3 Touch ▲ or ▼ to select the Heat and Cool temperatures, then touch **Next** to select return date.
- 4 Review the settings and touch **Done** to save them. Touch **Back**, then **Cancel** to ignore the changes.

 **NOTE:** The cool temperature can only be set higher than the unoccupied program setting and the heat temperature can only be set lower than the unoccupied program setting.

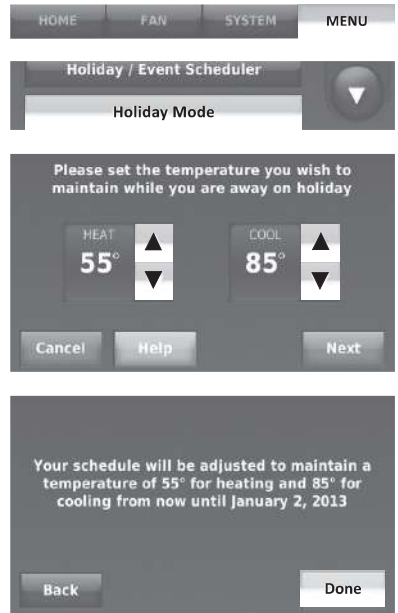

# Initiating occupancy mode: commercial use

This feature keeps temperature at an energy-saving level until you touch **Press to start occupancy**. When you arrive, touch the button to maintain a comfortable temperature while the room is occupied.

Touch the ▲ or ▼ buttons to set the temperature or the Hold Until time. The temperature is maintained until the time you set. Temperature returns to an energy-saving level after the timer expires, or the "Occupied" period ends.

 **NOTE:** This feature is available only when programmed by the installer.



## Remote setback (commercial use)

During Occupied program periods, an occupancy sensor directs the thermostat to go to REMOTE SETBACK settings when the room is empty. If someone is in the room, it uses the Occupied program period settings. The thermostat ignores the occupancy sensor during Unoccupied program periods.

If the thermostat is set up to be non-programmable, the sensor directs the thermostat to go to REMOTE SETBACK settings when the room is empty. If someone is in the room, then it follows the settings set by the user.

Depending on how your thermostat was installed, it may delay for up to 30 minutes before switching to REMOTE SETBACK settings. This delay allows the room to stay comfortable if the room is unoccupied for only a short time.

## Adjusting humidification settings

- 1 Touch **MENU** and select **Humidification**.
- 2 Select **Auto**.
- 3 Move the slider bar to select humidity level.
- 4 Touch **More Settings** if frost or condensation appears on the windows. Use a lower number to prevent frost or condensation. Use a higher number if indoor air is too dry. Window Protection limits the amount of humidity to prevent frost or condensation on windows. See notes below.
- 5 Touch **Done** to save your settings. Touch **Cancel** to ignore changes.



**NOTE:** The thermostat will not run the humidifier when the indoor humidity has reached the “Window Limit” that is displayed on the screen.



**NOTE:** Window Protection is available only if an outdoor air sensor is installed.

# Adjusting dehumidification settings: residential use

This feature can control a dehumidifier or use your air conditioner to reduce humidity.

- 1 Touch **MENU** and select **Dehumidification**.
- 2 Select **Auto**.
- 3 Move the slider bar to select humidity level.
- 4 Touch **Done** to save your settings. Touch **Cancel** to ignore changes.

 **NOTE:** If your air conditioner is used to control humidity, the temperature may drop up to 3° F below your temperature setting until humidity reaches the desired level.



# Adjusting dehumidification settings: commercial use

This feature can control a dehumidifier or use your air conditioner to reduce humidity.

- 1 Touch **MENU** and select **Dehumidification**.
- 2 Select **Auto**.
- 3 Move slider bar to select humidity level.
- 4 Touch **Done** to save your settings. Touch **Cancel** to ignore changes.

If your air conditioner is used to control humidity, the thermostat may use the following methods to maintain humidity:

- Cool from 1° to 5° F lower than your temperature setting.
- Run cooling for the minimum “on” time to reduce humidity.
- Run cooling and heating at the same time to reduce humidity without lowering the temperature.



# Adjusting ventilation settings

- 1 Touch **MENU**, and select **Ventilation**.
- 2 Touch **Setting**, then select:
  - Auto:** Ventilation runs as programmed by the installer.
  - Off:** Ventilation remains off unless turned on using the timer.
  - On:** Ventilation is always on.
- 3 Touch ▲ or ▼ to run ventilation temporarily. To turn it off, set it to zero.
- 4 Touch **More Settings** to set maintenance reminders and lockouts. Select **Yes** to prevent ventilation from running during the Sleep or Unoccupied (commercial) program periods or when outdoor conditions exceed values set by the installer.

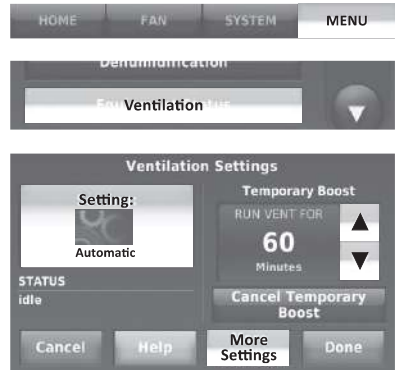

 **NOTE:** If set up for humidification in heat mode, the ventilator will turn on to remove excess humidity if 10% or more above your humidity setting.

# Setting preferences

Preference menu options let you select how the thermostat displays information or responds to certain situations.

- 1 Touch **MENU** and select **Preferences**.
- 2 Select an option and follow prompts:
  - Reminders to change filters
  - Display heat/cool diagnostic alerts
  - Utility Schedule options
  - Fahrenheit/Celsius display
  - 12/24-hour clock display
  - Screen color and brightness
  - Language choice
  - Scheduling options
  - Adaptive Intelligent Recovery
  - Restore default schedule
  - Daylight saving time
- 3 Touch **Done** to save your settings. Touch **Cancel** to ignore changes.

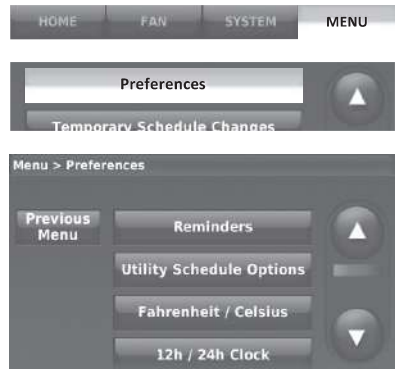

# Cleaning the thermostat screen

When you select the Clean Screen option, the screen is locked so you don't accidentally change settings while you clean.

- 1 Touch **MENU**.
- 2 Select **Clean Screen**. A prompt asks if you want to clean the screen for 30 seconds.
- 3 Touch **Yes**. A countdown timer displays elapsed time until the screen is reactivated.

 **NOTE:** Do NOT spray any liquid directly on the thermostat. Spray liquids onto a cloth, then use the damp cloth to clean the screen. Use water or household glass cleaner. Avoid abrasive cleansers.



# Adjusting security settings

You can adjust security options to prevent unauthorized changes to system settings.

- 1 Touch **MENU** and select **Security Settings**.
- 2 Select **Change Lock Mode**.
- 3 Select an option and follow prompts:

**Unlocked:** Full access allowed.

**Partially locked:** Only temperature can be changed.

**Fully locked:** No access allowed.

 **NOTE:** If you choose to use a password for additional security, write it here for reference:

--	--	--	--



# Viewing dealer information

Check dealer information if you need to contact your installer for maintenance, repairs, or upgrades.

- 1 Touch **MENU**.
- 2 Select **Dealer Information**.
- 3 Touch **Done** to return to the menu.



# Advanced features

**Adaptive Intelligent Recovery** (residential use only)—Over time, the Presitge® thermostat “learns” how long it takes your system to reach the temperature you want. It turns on the heating or cooling system earlier to make sure you’re comfortable at the time you expect. The thermostat displays “In Recovery” when it turns the system on early.

**Dehumidification Away Mode**—Your system can be set to control indoor climate while your home is vacant during the humid season. Before you leave, press **MENU**, then select **Dehumidification Away Mode**. Temperature and humidity will be kept at levels that protect your home and possessions. When you return, press **Cancel** to resume normal operation.

**Compressor Protection**—The thermostat keeps the compressor off for a few minutes before restarting, to prevent equipment damage. During this “off” time, the message “waiting for equipment” is displayed on screen.

**Pre-occupancy Purge** (commercial use only)—This feature turns on the fan 1 to 3 hours before each “occupied” time period, to provide a comfortable work environment when you arrive.

# Installer options

Installer Options require a password and should only be changed by a qualified technician.

To prevent unintended changes or damage to your equipment, **do not change these options yourself.**



# Replacing outdoor sensor batteries

Replace batteries in your outdoor sensor when a warning appears on the thermostat screen, about 60 days before batteries are depleted.

To replace the batteries:

- 1 Remove the sensor from the bracket.
- 2 Detach cover.
- 3 Insert 2 fresh AA lithium batteries.
- 4 Replace cover and set sensor back into bracket.

The outdoor sensor will restore communication with the thermostat a few seconds after new batteries are installed.

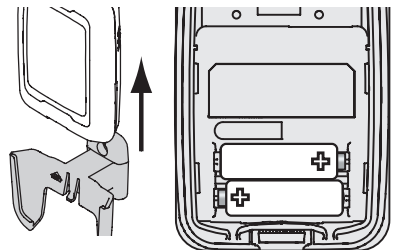

# Replacing indoor sensor batteries

Replace batteries in your indoor sensor when a warning appears on the thermostat screen, about 60 days before batteries are depleted. When the sensor status light begins flashing red, battery power is critically low and will be depleted within 2–3 weeks. During normal operation, the status light remains off.

To replace the batteries:

- 1 Remove the sensor from wallplate.
- 2 Install 2 fresh AAA alkaline batteries. If the status light flashes green, batteries are good; if it flashes red, you must use fresh batteries.
- 3 Attach sensor to wallplate.

The sensor will restore communication with the thermostat a few seconds after new batteries are installed.

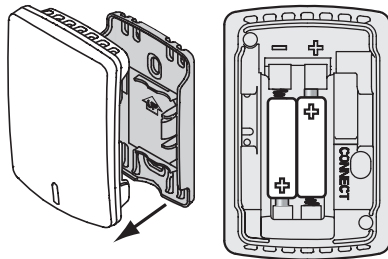

# Using the temperature display

In some circumstances, the temperature displayed on the Home screen may not match the temperature near the thermostat. If your system is set up to use remote indoor sensors, it may be reading a sensor in another location.



Temperature reading depends on location of sensor

# Using the humidity display

In some circumstances, the humidity displayed on the Home screen may not match humidity near the thermostat.

Some systems are set up to use two sensors, one to control humidification, the other for dehumidification. These sensors are often installed in different locations.

Depending on how your thermostat was installed, the thermostat Home screen will display humidity readings from only one sensor.



Humidity reading depends on location of sensor.

## Optional accessories

### Portable Comfort Control

If you have only one thermostat, you move this remote control from room to room (like a portable thermostat), to make sure the temperature is comfortable in the room you're using. If you have multiple thermostats, you can view and adjust the temperature in each room from your armchair.



### Wireless Outdoor Sensor

With a wireless outdoor sensor, your Prestige® thermostat can display outside temperature and humidity. This information can also be displayed on your handheld Portable Comfort Control.



### Wireless Indoor Sensor

If an indoor sensor is installed, your Prestige® thermostat will respond to temperature and humidity readings at the sensor location – providing comfort where the sensor is located. With multiple sensors, the thermostat can average temperature readings from each, to optimize comfort throughout your home.



# Optional accessories

## RedLINK™ Internet Gateway

The RedLINK Internet Gateway gives you remote access to your Prestige® thermostat from the web, smart phone or tablet. You can view or adjust indoor temperature, system mode and other settings. The Gateway can also send alerts to as many as 6 email addresses to notify you if a problem occurs.



## Wireless Entry/Exit Remote

This device mounts beside your door for one-touch control. Press **Away** to control to an energy saving temperature when you leave home. Press **Home** to control to a comfortable temperature when you return. To change pre-set temperatures, go to **MENU > Entry/Exit Remote Settings**.



## Wireless Vent and Filter Boost Remote

This device mounts anywhere in your home (typically bathroom or kitchen) for convenient, on-demand ventilation. For increased ventilation, select 20, 40, or 60 minutes.



# Troubleshooting

If you have difficulty with your thermostat, try these suggestions. Most problems can be corrected quickly and easily.

### Screen is blank

- Check circuit breaker and reset if necessary.
- Make sure power switch at heating and cooling system is on.
- Make sure furnace door is closed securely.

### Screen is difficult to read

- Change screen brightness using Preferences menu (see page 14).
- At 2 am each day, Prestige thermostats change screen colors for an hour, to prevent burn-in. Touch the screen at any time to restore pre-set screen colors.

### Heating or cooling system does not respond

- Touch **SYSTEM** to set system to Heat. Make sure the temperature is set higher than the Inside temperature.
- Touch **SYSTEM** to set system to Cool. Make sure the temperature is set lower than the Inside temperature.
- Check circuit breaker and reset if necessary.
- Make sure power switch at heating & cooling system is on.
- Make sure furnace door is closed securely.
- If “Waiting For Equipment” is displayed, the compressor protection timer is on. Wait 5 minutes for the system to restart safely, without damaging the compressor.

# Up to 5-year limited warranty

Resideo warrants this product, excluding battery, to be free from defects in workmanship or materials, under normal use and service, for a period of five (5) years from the date of first purchase by the original purchaser. If at any time during the warranty period the product is determined to be defective due to workmanship or materials, Resideo shall repair or replace it (at Resideo's option).

If the product is defective,

- (i) return it, with a bill of sale or other dated proof of purchase, to the place from which you purchased it; or
- (ii) call Resideo Customer Care at 1-800-468-1502. Customer Care will make the determination whether the product should be returned to the following address: Resideo Return Goods, 1985 Douglas Dr. N., Golden Valley, MN 55422, or whether a replacement product can be sent to you.

This warranty does not cover removal or reinstallation costs. This warranty shall not apply if it is shown by Resideo that the defect was caused by damage which occurred while the product was in the possession of a consumer.

Resideo's sole responsibility shall be to repair or replace the product within the terms stated above. RESIDEO SHALL NOT BE LIABLE FOR ANY LOSS OR DAMAGE OF ANY KIND, INCLUDING ANY INCIDENTAL OR CONSEQUENTIAL DAMAGES RESULTING, DIRECTLY OR INDIRECTLY, FROM ANY BREACH OF ANY WARRANTY, EXPRESS OR IMPLIED, OR ANY OTHER FAILURE OF THIS PRODUCT.

Some states do not allow the exclusion or limitation of incidental or consequential damages, so this limitation may not apply to you.

THIS WARRANTY IS THE ONLY EXPRESS WARRANTY RESIDEO MAKES ON THIS PRODUCT. THE DURATION OF ANY IMPLIED WARRANTIES, INCLUDING THE WARRANTIES OF MERCHANTABILITY AND FITNESS FOR A PARTICULAR PURPOSE, IS HEREBY LIMITED TO THE FIVE YEAR DURATION OF THIS WARRANTY. Some states do not allow limitations on how long an implied warranty lasts, so the above limitation may not apply to you.

This warranty gives you specific legal rights, and you may have other rights which vary from state to state. If you have any questions concerning this warranty, please write Resideo Customer Care, 1985 Douglas Dr, Golden Valley, MN 55422 or call 1-800-468-1502.

## Regulatory information

### **FCC Compliance Statement (Part 15.19) (USA only)**

This device complies with Part 15 of the FCC Rules. Operation is subject to the following two conditions:

- 1 This device may not cause harmful interference, and
- 2 This device must accept any interference received, including interference that may cause undesired operation.

### **FCC Warning (Part 15.21) (USA only)**

Changes or modifications not expressly approved by the party responsible for compliance could void the user's authority to operate the equipment.

### **FCC Interference Statement (Part 15.105 (b)) (USA only)**

This equipment has been tested and found to comply with the limits for a Class B digital device, pursuant to Part 15 of the FCC Rules. These limits are designed to provide reasonable protection against harmful interference in a residential installation. This equipment generates uses and can radiate radio frequency energy and, if not installed and used in accordance with the instructions, may cause harmful interference to radio communications. However, there is no guarantee that interference will not occur in a particular installation. If this equipment does cause harmful interference to radio or television reception, which can be determined by turning the equipment off and on, the user is encouraged to try to correct the interference by one of the following measures:

- Reorient or relocate the receiving antenna.
- Increase the separation between the equipment and receiver.
- Connect the equipment into an outlet on a circuit different from that to which the receiver is connected.
- Consult the dealer or an experienced radio/TV

technician for help.

### **Equipment interface module, thermostats and outdoor sensor**

To comply with FCC and Industry Canada RF exposure limits for general population/ uncontrolled exposure, the antenna(s) used for these transmitters must be installed to provide a separation distance of at least 20 cm from all persons and must not be co-located or operating in conjunction with any other antenna.

### **Portable Comfort Control**

This portable transmitter with its antenna complies with FCC and Industry Canada RF exposure limits for general population/ uncontrolled exposure. This device must not be co-located or operating in conjunction with any other antenna or transmitter.

### **Section 7.1.2 of RSS-GEN**

Under Industry Canada regulations, this radio transmitter may only operate using an antenna of type and maximum (or lesser) gain approved for the transmitter by Industry Canada. To reduce potential radio interference to other users, the antenna type and its gain should be so chosen that the equivalent isotropically radiated power (e.i.r.p.) is not more than that necessary for successful communication.

### **Section 7.1.3 of RSS-GEN**

Operation is subject to the following two conditions:

- 1 This device may not cause interference, and
- 2 This device must accept any interference, including interference that may cause undesired operation of the device.